

Verify, and adjust if necessary, centering of Rack and Pinion before installing.

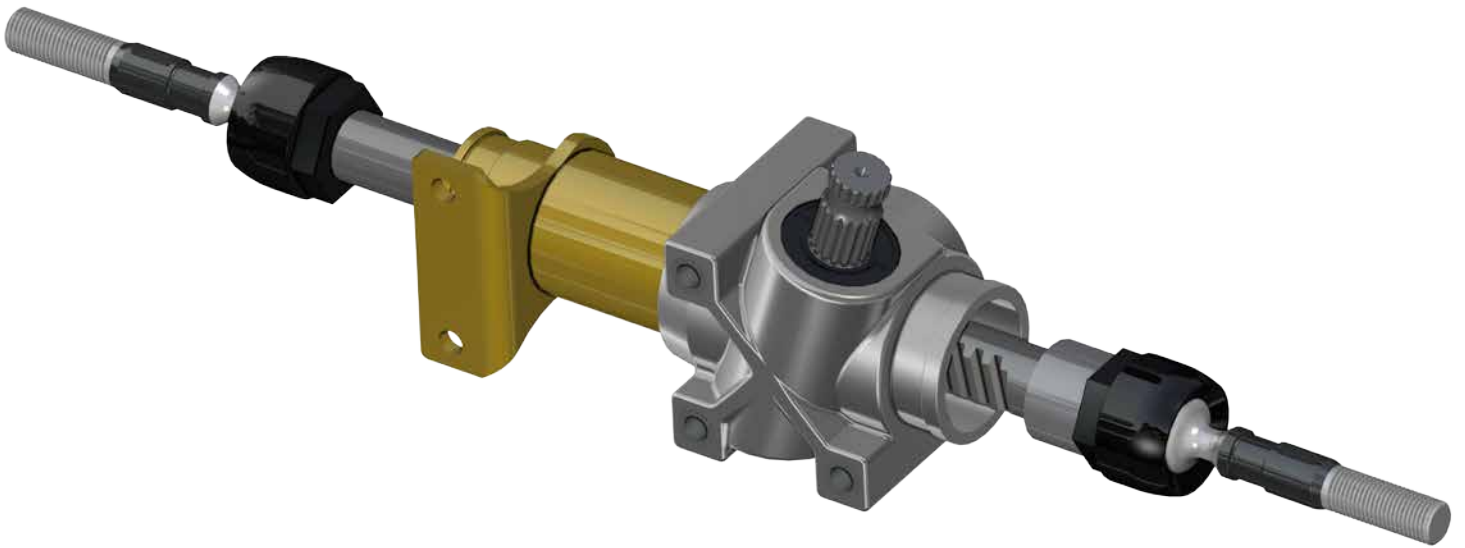

1. Measure distance from inside of Rack and Pinion to face of Tie Rod End.
 2. Measure distance from face of Tie Rod End to housing face.
 3. Adjust Rack and Pinion until measurements are equal.
- Mark center.

(illustrations on following page)

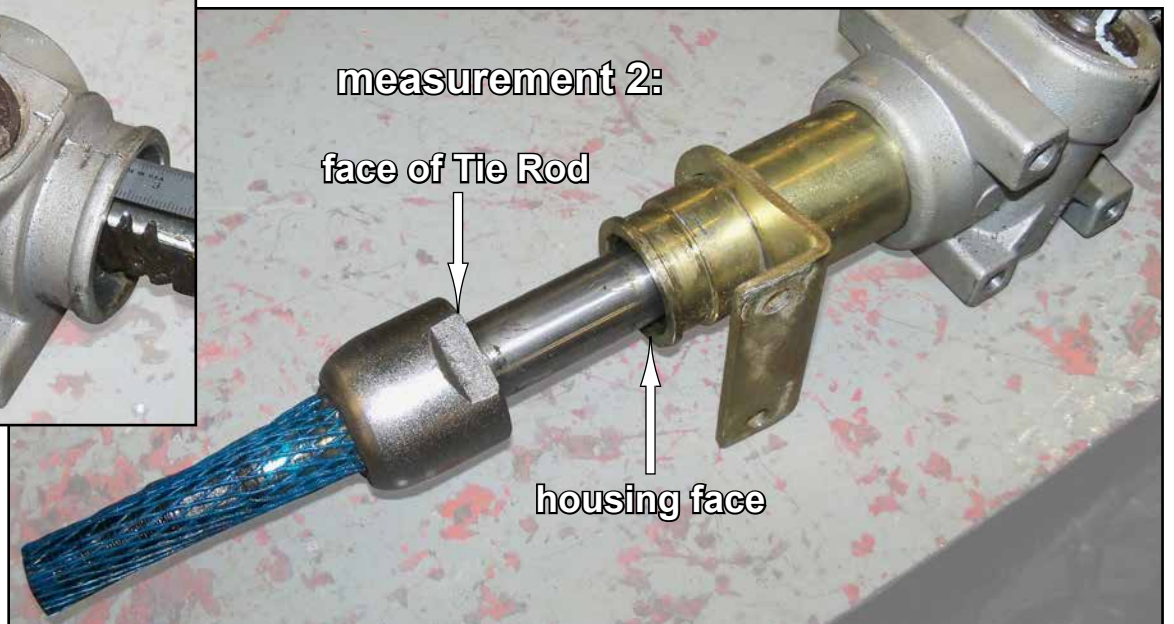
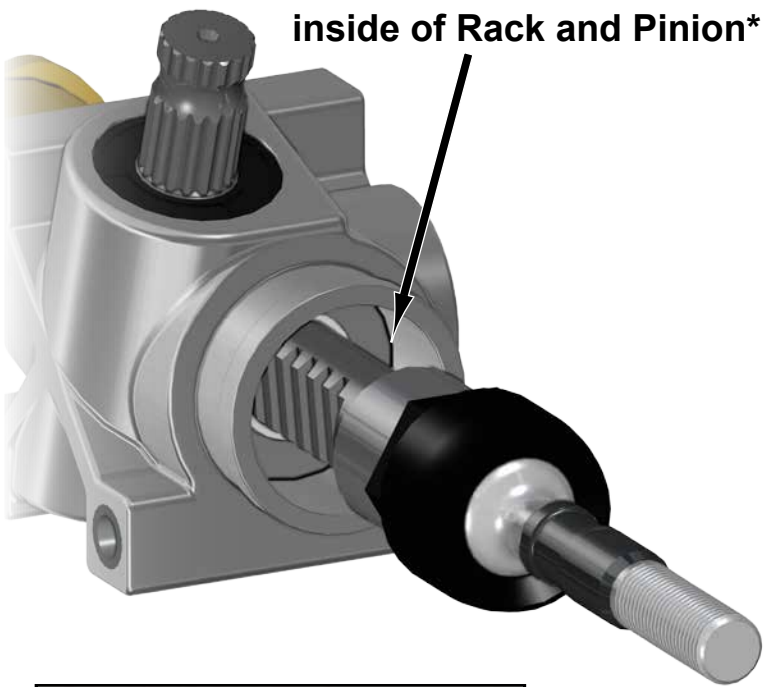
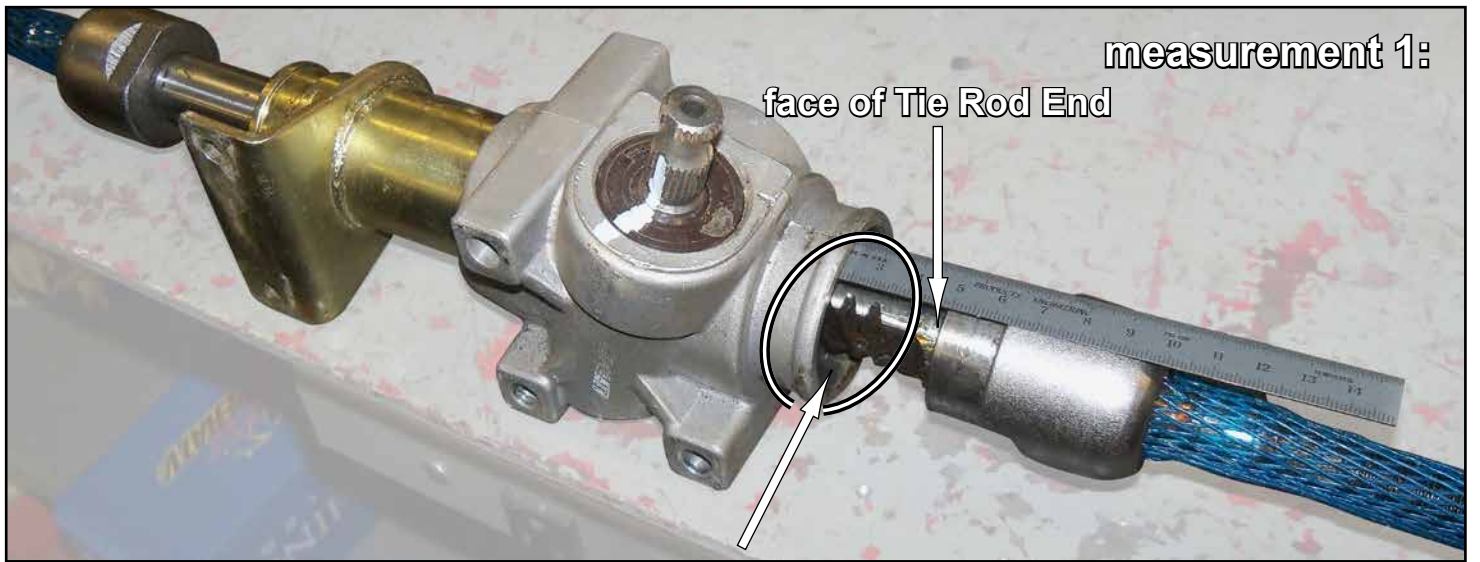

INSTALLATION INSTRUCTIONS
Heavy Duty Rack and Pinion
 for multiple Polaris RZR[®] XP models

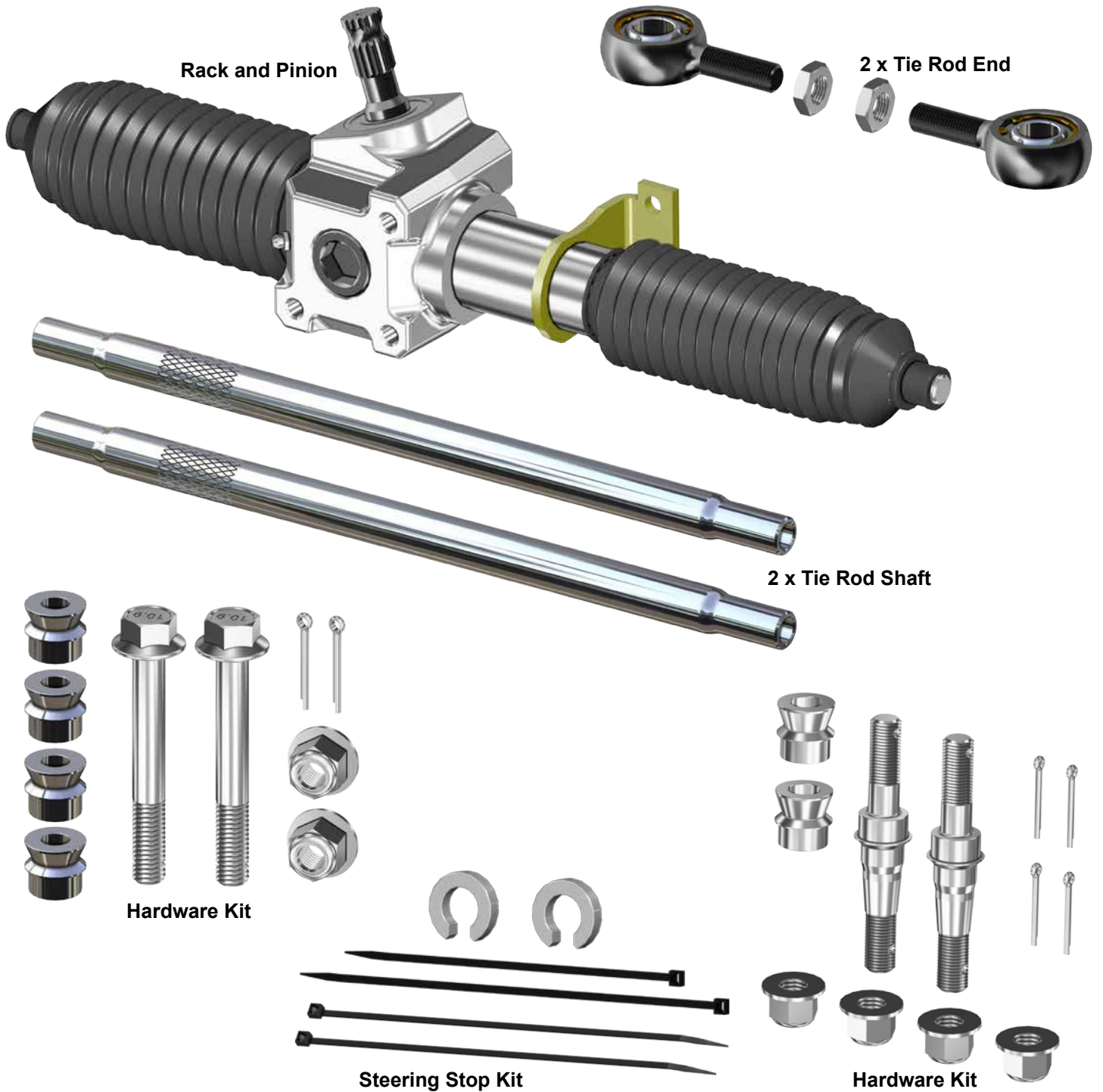

Rack and Pinion

2 x Tie Rod End

2 x Tie Rod Shaft

Hardware Kit

Steering Stop Kit

Hardware Kit

Need help with your installation?

✉ sales@superatv.com 💻 www.superatv.com

☎ 1-855-743-3427 🕒 8:00am - 8:00pm EST M-Th
 8:00am - 7:00pm EST Friday
 9:00am - 2:00pm EST Saturday

Read instructions and view illustrations before beginning.

Thank You
For Choosing
SUPERATV.COM[®]

Rack and Pinion Removal: *Keep all hardware and components removed.*

1. Raise front of vehicle and secure with jack stands. Remove Wheels.
2. Remove (4) Differential Bolts. See Fig. 1.
 - Remove Tie Rods from machine. See Fig. 2.
 - **FROM ONE SIDE ONLY**, remove Shocks from A-Arm, disconnect A-Arms from Spindle, and remove Axle. See Fig. 2.
3. Remove hardware from Lower U-Joint. See Fig. 3.
4. Remove hardware from stock Rack and Pinion. See Fig. 3.
5. Proceed to "Rack and Pinion Installation".

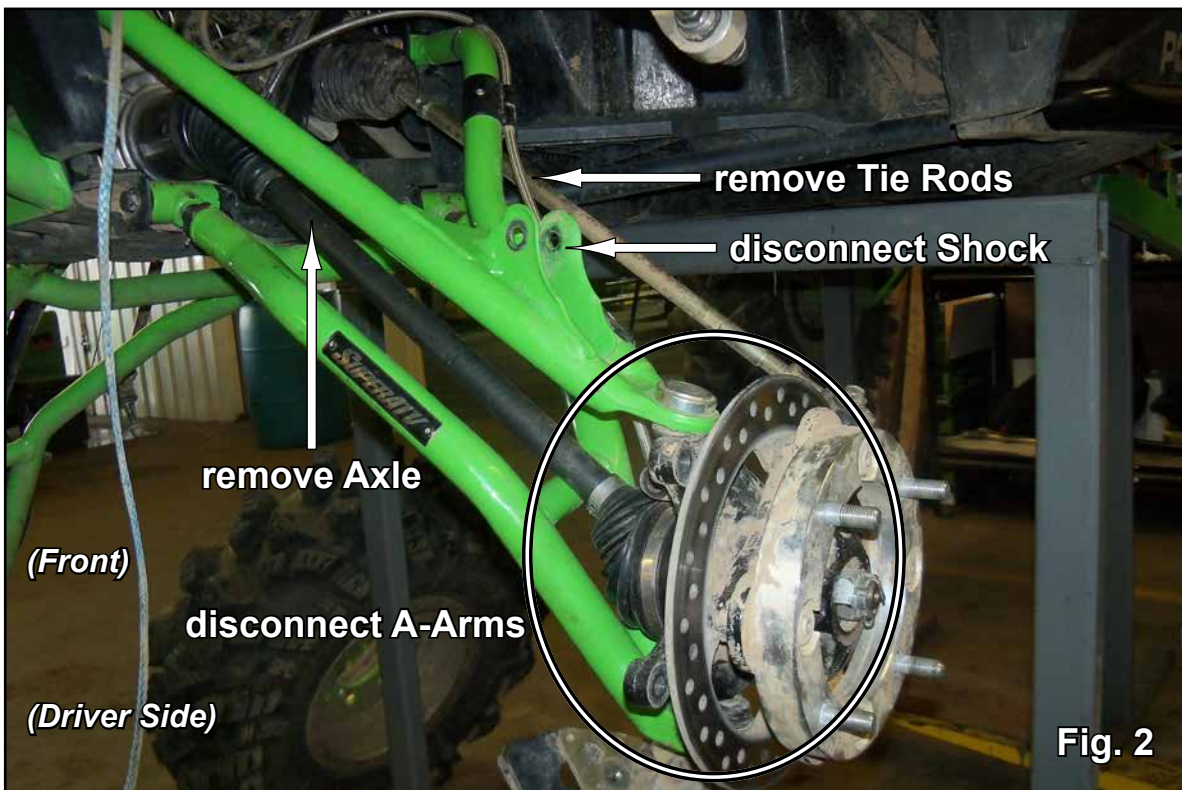
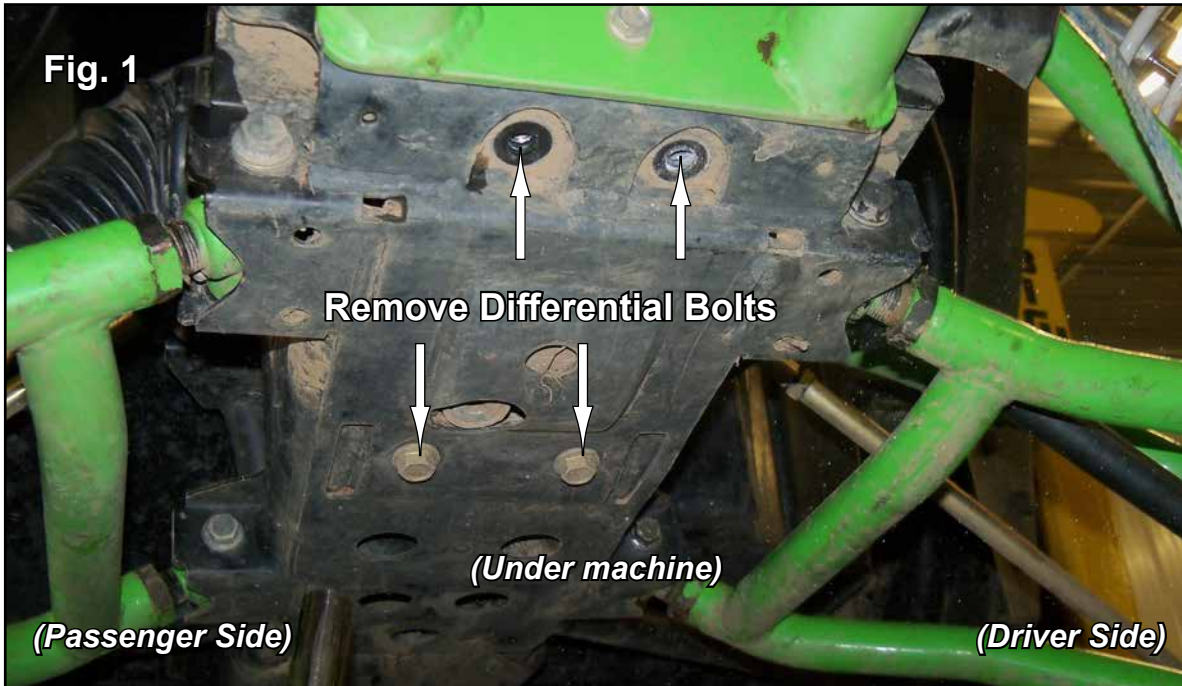

(removal illustrations continue on following page)

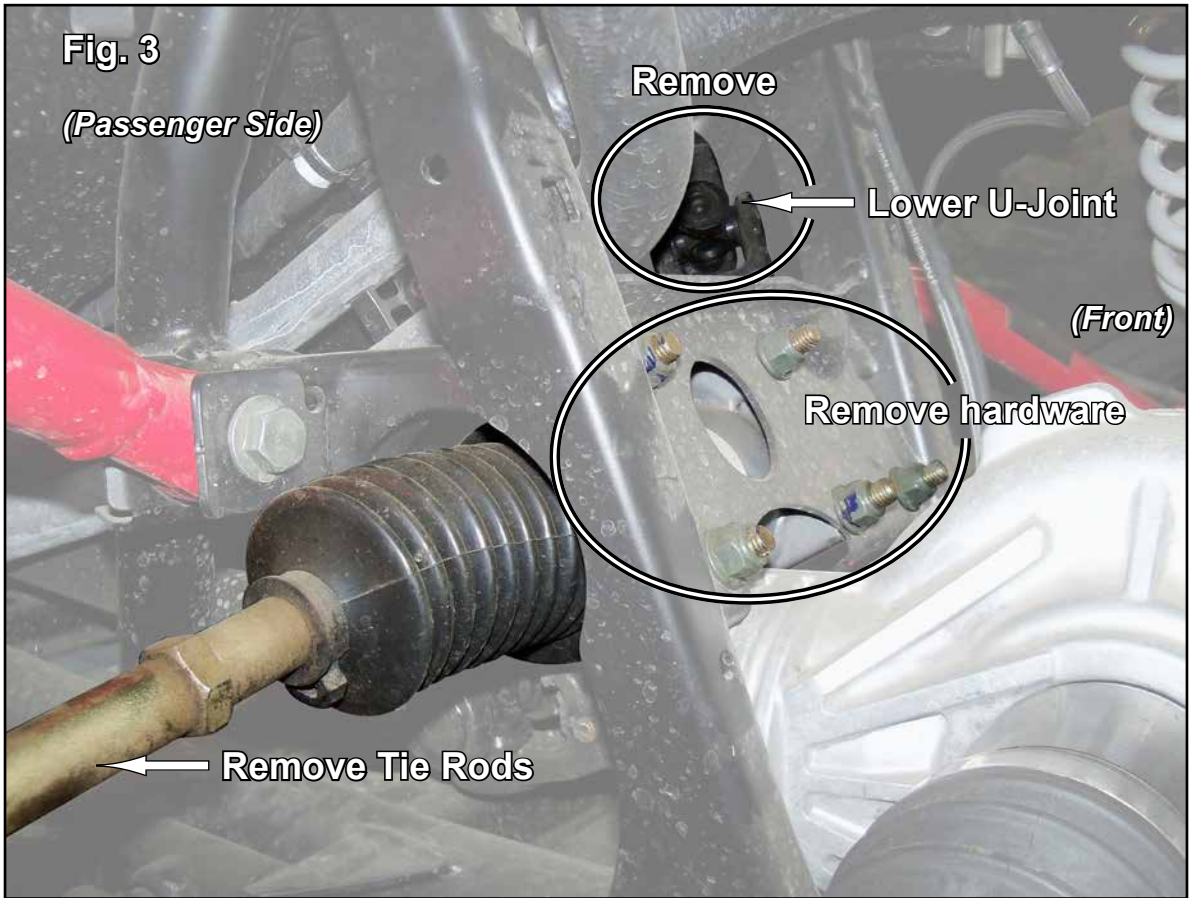

Steering Stops Installation:

- Unclamp and slide Boot away from Rack and Pinion.
- Install Steering Stop onto Shaft.



- Resecure Boot with Wire Tie.

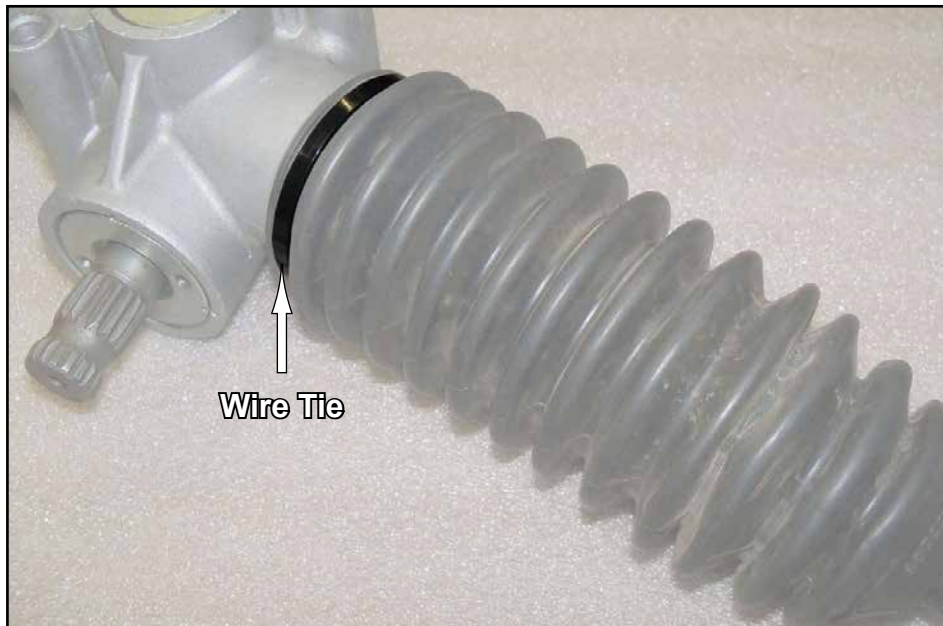

- Repeat steps for opposite Shaft.

Rack and Pinion Installation: *Do not tighten hardware completely unless noted.*

- Install Rack and Pinion to machine with hardware shown.
- Reinstall Steering Shaft to Rack and Pinion with stock hardware.
- Tighten all hardware completely.
- Proceed to "Tie Rod Installation".

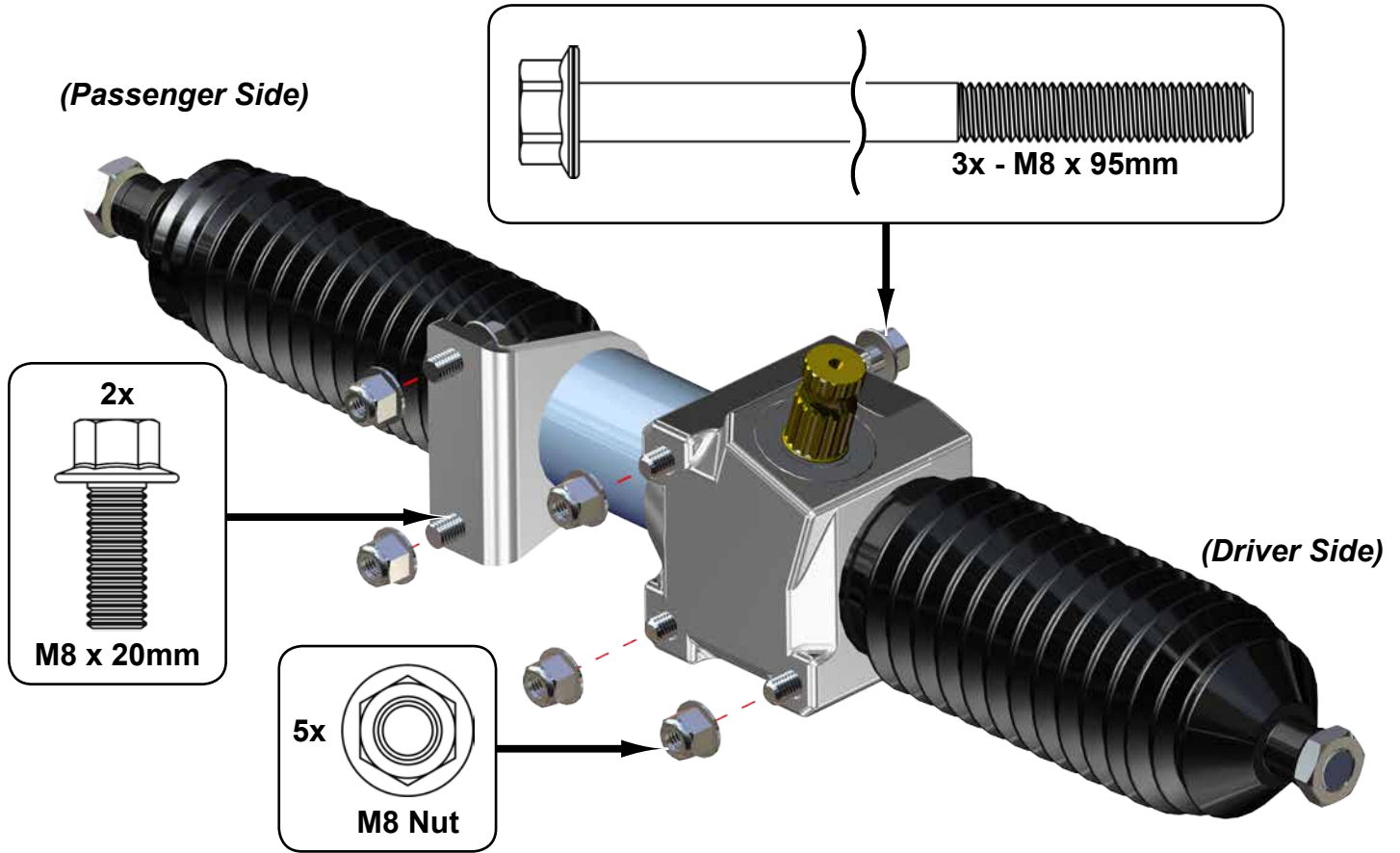

Tie Rod Installation:

- Install Tie Rod Shafts to Ball and Sockets on Rack and Pinion.
- Install Tie Rod Ends to Tie Rod Shafts.
- Secure Tie Rod Ends to same location as stock on Spindles with appropriate hardware.

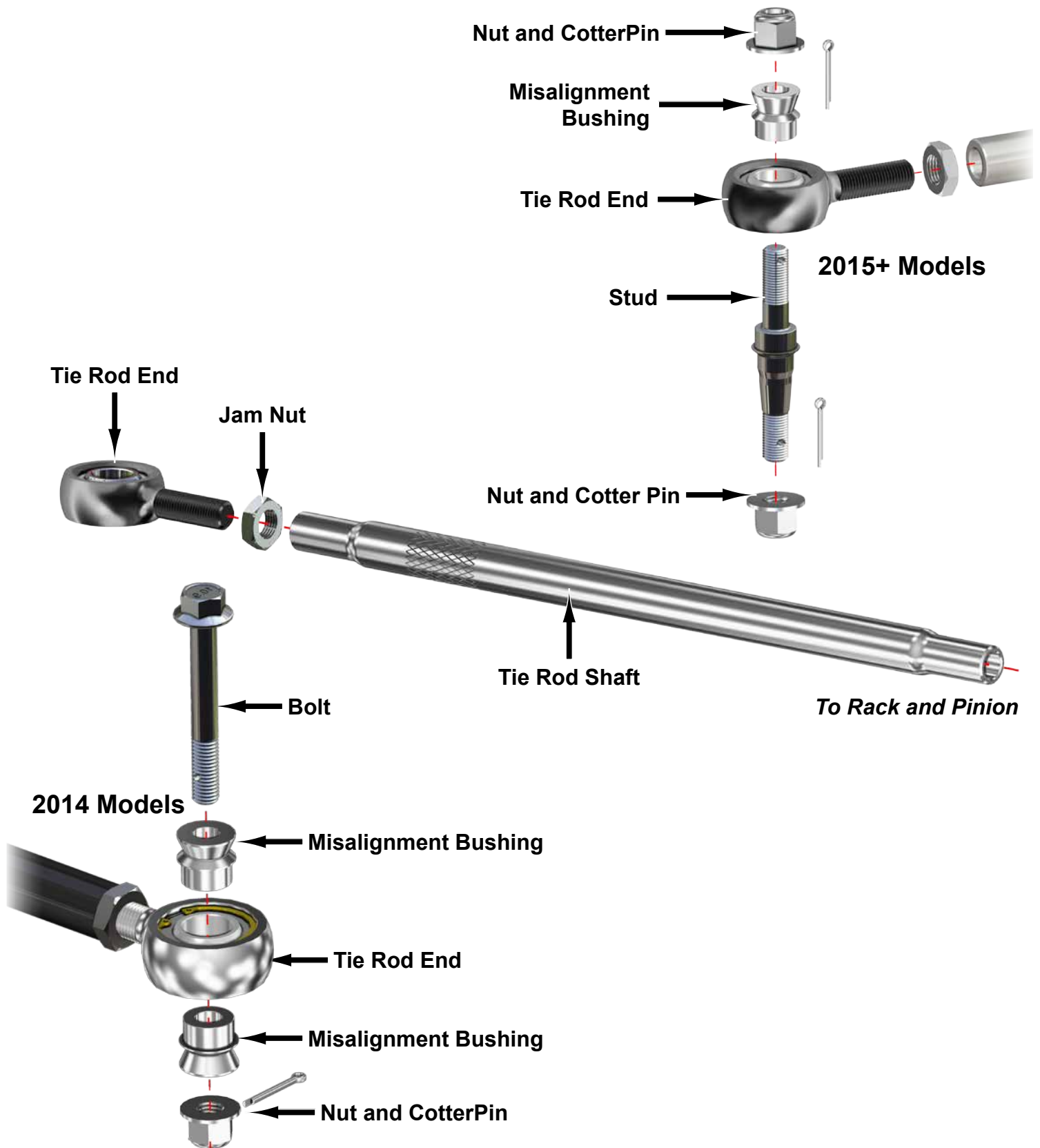

- Reinstall necessary components.
- Before initial ride, set toe-in of vehicle.
- After initial ride check to see that hardware remained tight.

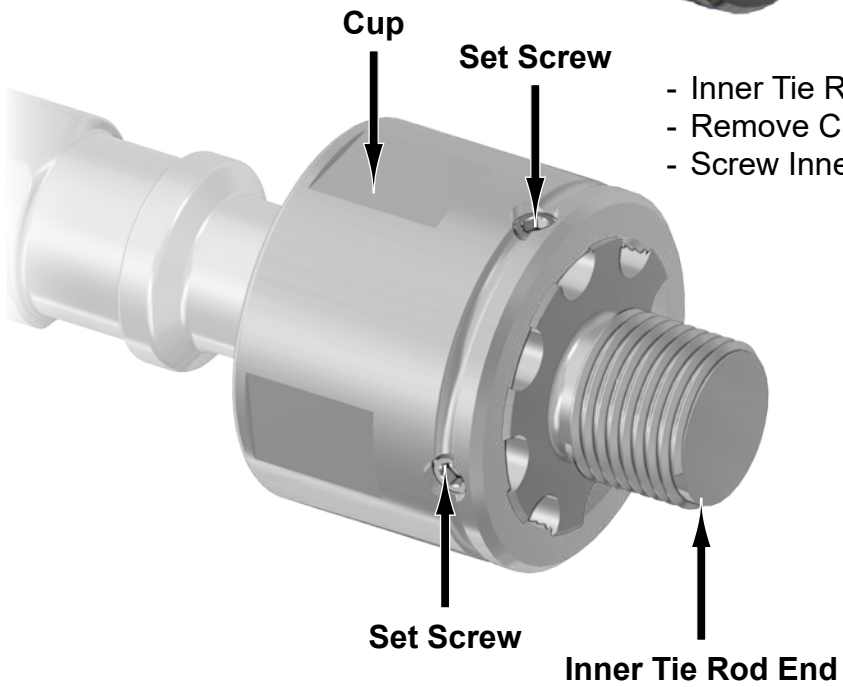

- Inner Tie Rod End is adjustable and can be tightened.
- Remove Clip and loosen (4) Set Screws
- Screw Inner Tie Rod End into Cup.